



pearson  
ferrier®



7 CLIFF MOUNT  
Ramsbottom, BL0 9EP  
£220,000

# 7 CLIFF MOUNT

## Property at a glance

- stone built terrace
- elevated setting with views over the town
- requires some renovation
- sought after location
- patio garden
- no onward chain

A two bedroom stone built elevated terrace property located in this popular hillside setting within easy reach of the Ramsbottom town centre and the motorway network. The property benefits from gas fired central heating system and is double glazed throughout. Briefly comprising entrance, lounge, fitted kitchen. First floor, two bedrooms and a three piece bathroom suite. There is a garden forecourt to the front and to the rear a communal area with off road parking.

Please note there is a holding deposit equivalent to one weeks rent payable to secure the property.





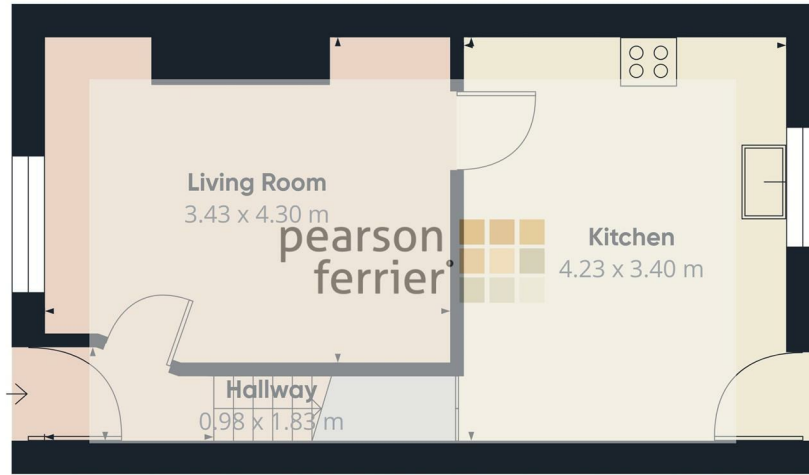

Floor 0

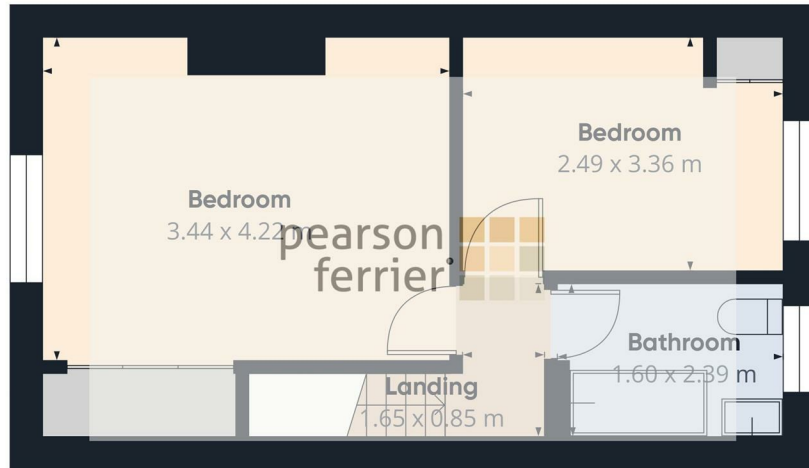

Floor 1



Approximate total area<sup>(1)</sup>  
61.9 m<sup>2</sup>

(1) Excluding balconies and terraces

Calculations reference the RICS IPMS 3C standard. Measurements are approximate and not to scale. This floor plan is intended for illustration only.

GIRAFFE360

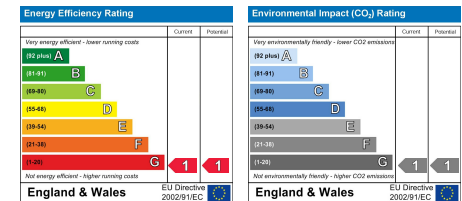

Ramsbottom Office  
11 Bolton Street, Ramsbottom, BL0 9HU  
Telephone: 01706 822630  
Fax: #  
Email: ramsbottom@pearsonferrier.co.uk

[www.pearsonferrier.co.uk](http://www.pearsonferrier.co.uk)



All statements contained in these particulars are for indicative purposes only and are made without responsibility on the part of Pearson Ferrier and the vendors of this property and are not to be relied on as statements or representations of fact. Potential purchasers should satisfy themselves by inspection or otherwise as to the accuracy of such details contained in these particulars.